



Vortex Mixer

Model YR05007

Instruction Manual

Thank you very much for purchasing our Kalstein Vortex Mixer Model YR05007

Please read the "Operating Instructions" and "Warranty" before operating this unit to assure proper operation. After reading these documents, be sure to store them securely together with the "Warranty" at a hand place for future reference.



Warning: Before operating the unit, be sure to read carefully and fully understand important warnings in the operating instructions.



OUR SERVICES

Benefits and Support

In Kalstein France, we take care of the full satisfaction of our customers, that is why we provide value-added services of the highest level based on our experience.



Online Inductions and Trainings

In any part of the world, receive your induction or training from our specialized team of engineers



Quick Response

Our work team is always available to response all your consults or questions, in order to support you in any situation.



#Letsgivemore ♥

Thanks to your purchase, a donation will be made to a non-profit foundation that fights against breast cancer and helps most vulnerable communities.



Technical Support

Enjoy of personalized advice for the correct preventive and corrective maintenance of your equipment, thanks to Kalstein's manuals and articles, special catalogues and video tutorials.



Delivery Logistics

We take care of all the necessary logistics for the dispatch of your goods, whether is by sea, land or air.



Kalstein Worldwide

With more than 25 years growing with our customers, Kalstein's multiformat and modern content, is now present in more than 10 countries and increasing.





I. Brief introduction

This brand of vortex mixer adopts international advanced design concept and manufacturing technologies, and has the advantages of smooth and beautiful appearance, compact and firm structure, high versatility, and simple operation. It is a rare instrument for scientific research. This vortex mixer is mainly used to prevent blood coagulation, immunoprecipitation and other similar laboratory purposes. It is mainly used for molecular hybrid blood and other samples that need to be mixed

II. Product overview and introduction

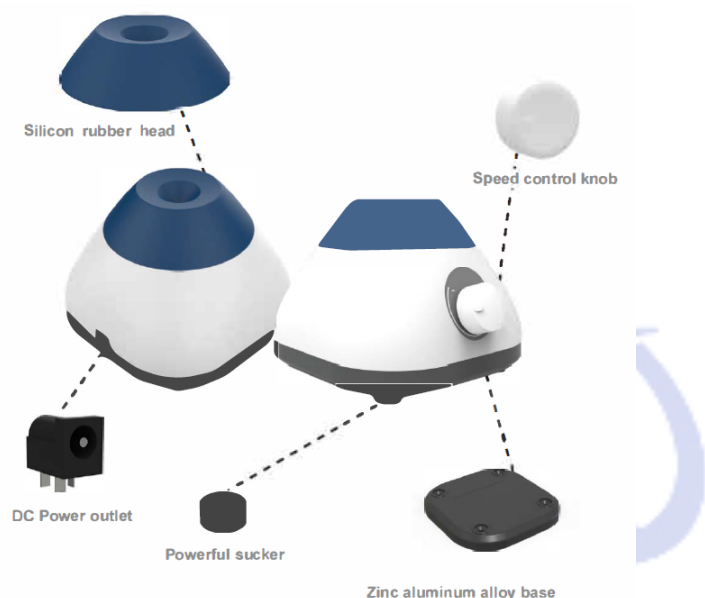

III. Technical Data

Model	YR05007
Control mode	Knob-style(adjustable speed)
Motor type	Brushless motor
Orbital diameter(mm)	4.5
Max handing volume(ml)	50
Speed range(rpm)	3000
Protection class acc	IP42
Output power(w)	12
voltage	100-240v,50/60Hz
Permissible relative humidity	5-40°C,80%RH
Product dimension(mm)	100*93*72
Package dimension(mm)	190*126*113
Product weight(kg)	0.56/0.37



IV: Operation guide

Application

It is mainly used for molecular hybrid blood and other samples that need to be mixed.

Applied area

It is widely used as an experimental tool in institutions of higher learning, environmental protection, sanitation, epidemic prevention, chemical industry, tap water and medical treatment

Using Steps

1. Plug it in and turn the knob to the right to adjust the speed
2. Place the centrifuge tube or test tube to the top center, click mode, touch and press lightly to run.

Instrument use environment

1. In door use
2. Altitude: $\leq 2000\text{m}$.
3. The working temperature range of the instrument is: $+5^{\circ}\text{C}\sim+40^{\circ}\text{C}$.
4. The working temperature range of the instrument is $\leq 80^{\circ}\text{C}$.
5. There are no vibrations and airflows around to effect performance.
6. No conductive dust, explosive gas and corrosive gas around.
7. Maintain a safe distance of 10cm from front to back, left and right when working.

Safety Precautions

1. Do not plug or unplug the power connector and toggle the p-ower button when the hands are stained with liquid
2. Do not plug or unplug the power plug when the instrument is powered.
3. It is strictly forbidden to maintain and scrub the instrument under power-on state.
4. It is strictly forbidden to install the instrument on a work surface that is uneven and shakes.

V: Opening Check

The packing list when you first open the instrument packing case. If you find there is something wrong with the Instrument and the Appendix, do contact the vendor or the producer.

Delivery package

Vortex Mixer x1 & User's Manual x1 & Power cable x1

